



MATIZOL COLOR DECK

ANTI-SLIP COATING FOR BALCONIES AND TERRACES

1. PRODUCT DESCRIPTION

Elastomeric, liquid waterproofing coating designed for protecting outdoor surfaces such as balconies and terraces. With its unique formula enriched with quartz sand, **MATIZOL COLOR DECK** not only creates a waterproof barrier but also provides excellent anti-slip properties. This versatile coating is designed for easy application and long-lasting effects. It requires no priming, and only two layers are needed, using basic painting tools like rollers or brushes. The product is intended for both protecting and finishing newly constructed terraces and balconies, as well as revitalizing existing finishes, whether they are concrete slabs, porcelain tiles, bitumen, or ceramic tiles.



AVAILABLE COLOURS:

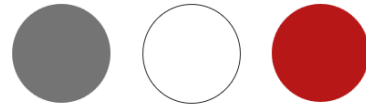

2. BENEFITS

- ANTI-SLIP
- WATERPROOF
- ONLY 2 LAYERS, NO PRIMER

3. APPLICATION AREA

The product is used to create anti-slip and waterproof surfaces on terraces and balconies.

4. SUBSTRATES

- concrete
- bitumen felts
- brick
- fiber-cement boards
- natural stone
- wood, including OSB

*For metal surfaces, always perform a test application to verify final adhesion

5. SUBSTRATE PREPARATION

Thoroughly clean the surface of dust, loose parts, oil or unbonded with substrate substances. Application must be carried out on a dry surface. Check that the substrate is not wet, to avoid air bubbles due to vapour pressure. The best treatment is to apply a polyethylene film sealed with adhesive tape on the side of the surface exposed to the sun and check after 24 hours for any condensation of water. If there is no condensed water, **MATIZOL COLOR DECK** can be applied. However, if condensation is present, wait for the substrate to dry completely. Gently mix the product before application.

6. APPLICATION

The product is ready to use and can be applied with a roller, brush, or airless spraying. Use between temperatures of +5°C to +35°C. To achieve a uniform thickness, apply **MATIZOL COLOR DECK** in two layers, 0,8 kg/m² each. Apply second layer once the previous layer is fully dry. Protect the surface from water, rain, and snow for the first 24 hours after application.

To ensure waterproof continuity, apply **MATIZOL CORNER TAPE PP-BUTYL** on perimeter edges. For waterproofing and sealing around openings like drains, ventilation pipes, and other installation passages, use **MATIZOL CORNER TAPE PP-BUTYL** and **MATIZOL COLLAR PP-BUTYL**, a self-adhesive square butyl pad.

Illustration 1. Application and treatment of details in the **MATIZOL COLOR DECK** system.

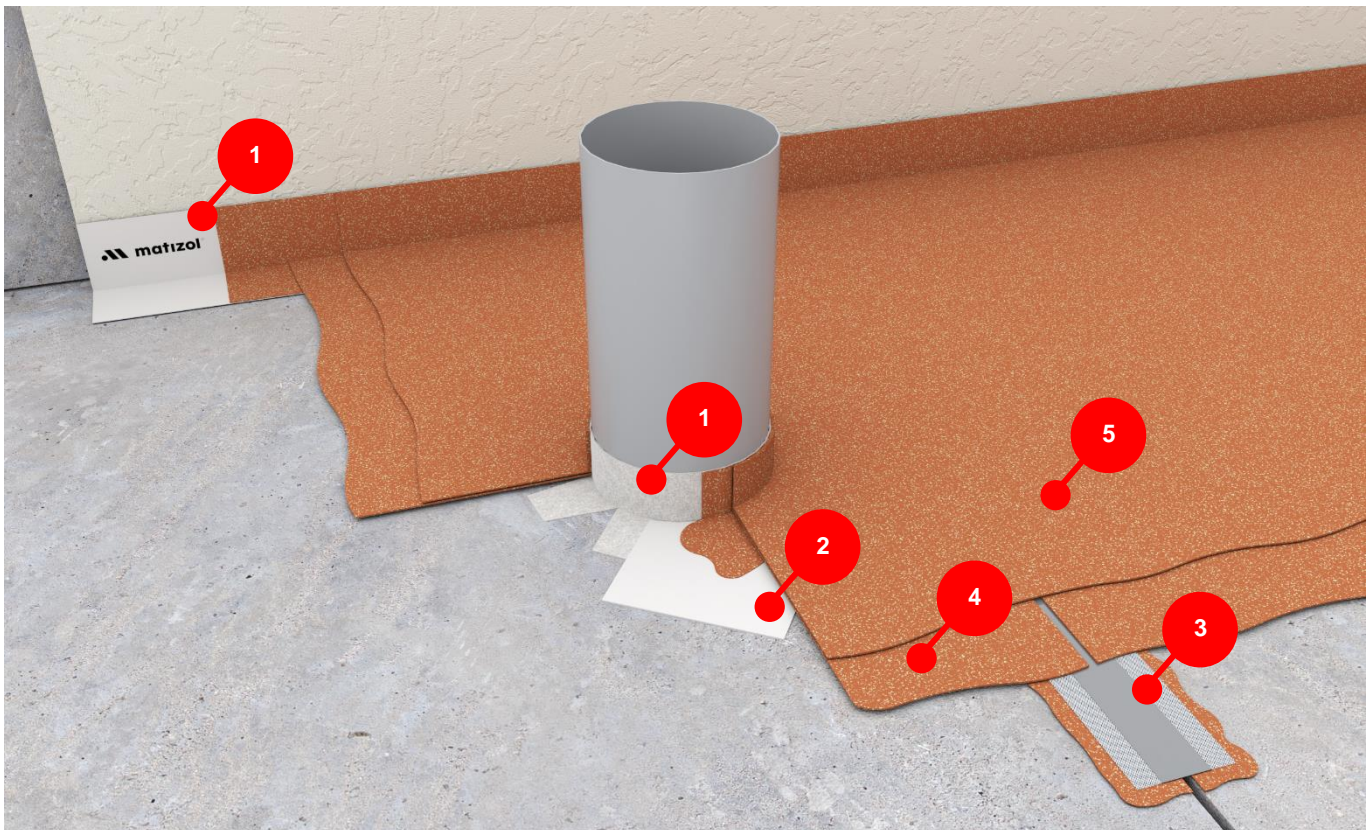



1. MATIZOL CORNER TAPE PP-BUTYL
2. MATIZOL COLLAR PP-BUTYL
3. MATIZOL JOINT TAPE PV-ELAST
4. first layer MATIZOL COLOR DECK: 0.8 kg/m²
5. second layer MATIZOL COLOR ROOF: 0.8 kg/m²

DRYING TIME

| | |
|------------------------------|------------|
| Dry to the touch | Up to 12 h |
| Application of second coat | 24 h |
| Resistance to standing water | 24 h |

(The above times may vary depending on ambient temperature and humidity.)

EXPANSION JOINTS:

TREATMENT OF CRACKS AND EXPANSION JOINTS UP TO 1 CM WIDE:

For coating applications in areas with cracks, gaps, or expansion joints, secure joints up to 1 cm wide using **MATIZOL JOINT TAPE PV-ELAST** (a waterproof, elastic tape made of elastomer and polyester fabric) as described below:

Apply **MATIZOL COLOR DECK** along the joint, right at its edge, and then lay the **MATIZOL JOINT TAPE PV-ELAST** over the joint, ensuring that the entire surface under the perforated part of the tape is uniformly covered with the product. After the coating has completely dried, proceed with the full surface application of the first layer.

TREATMENT OF CRACKS AND EXPANSION JOINTS WIDER THAN 1 CM:

To seal joints wider than 1 cm, use the following system:

For new joints or renovating existing ones, insert a BACKER ROD into the joint to a depth slightly greater than the rod's diameter. Ideally, the top of the rod should be at a depth equal to its radius (i.e., half its diameter). Then, fill the space above the rod with polyurethane sealant. Once the sealant is fully dry, apply **MATIZOL JOINT TAPE PV-ELAST** according to the instructions for "treatment of cracks and expansion joints up to 1 cm wide."

WARNINGS

No additives required.

Do not use if the packaging is damaged.

Do not add water and/or solvents.

7. PRECAUTIONS

When applying **MATIZOL COLOR ROOF** to bituminous membranes, the modified membrane must undergo oxidation for at least 180 days before the product is applied. Do not apply **MATIZOL COLOR DECK** to surfaces exposed to water stagnation; the surfaces must have proper slopes to ensure rainwater drains off by gravity. The product should be used in environmental conditions that ensure that it will dry completely in the shortest possible time. Therefore, do not apply it to frozen surfaces or during rainy weather. Protect the surface from water, rain, and snow for the first 24 hours after application. Use between +5°C and +35°C.

8. LOGISTIC DATA

| | |
|--------|------------------|
| Volume | Pails per pallet |
| 5 kg | 120 |
| 10 kg | 48 |

9. TECHNICAL PARAMETERS

| PROPERTIES | NORM | VALUE |
|------------------------------------|---------------|------------------------------|
| Yield – 2 layers | - | 1.6 kg/m ² |
| Application Temperature | - | +5°C - +35°C |
| Appearance | - | Paste |
| Colour | - | white/grey/red |
| Density at 20°C | EN ISO 2811-1 | 1.7 ± 0.05 g/cm ³ |
| Solid content | EN ISO 3251 | 55 ± 2% |
| pH | UNI 8490-4 | 9 ± 1 |
| Brookfield viscosity at 20°C (Cps) | UNI EN 8490 | 3000 ± 500 |

PERFORMANCE PROPERTIES (UNI EN 1504-2)

| PROPERTY | NORM | VALUE |
|--|---------------------|---|
| Water vapor permeability | EN 7783 | 5m ≤ Sd ≤ 50 m |
| Capillary absorption | EN 1062-3 | W < 0.1 kg/m ² ·h ^{0.5} |
| Coating adhesion (horizontal without traffic load) | EN 1542 | ≥1.5 N/mm ² |
| Thermal shock resistance (horizontal without traffic load) | EN 13687-5 | ≥1.5 N/mm ² |
| Fire reaction | EN 13501-1 | F |
| Weather resistance | - | Good |
| Temperature of use - under load | - | From -10°C to +80°C |
| Mechanical load | EAD 0303650-00-0402 | P2 |

EMISSION OF VOLATILE ORGANIC COMPOUNDS

| Parameter | Maximum permissible concentration (µ/m ³) |
|--------------------|---|
| TVOC after 3 days | ≤ 750 |
| TVOC after 28 days | ≤ 60 |

Test performed by EUROFINS according to EN 16516, ISO 16000-3-6-9-11 and ASTM D5116-10, Test Report No. 392-2018-00451601_G_EN_02

10. STORAGE & TRANSPORTATION

Store for up to 18 months in the original sealed containers. Containers should be stored in an upright position, away from sources of fire and heating elements, in conditions where they are protected from direct sunlight and weather influences. Cannot be stored in sub-zero temperatures. Permissible transport and storage temperature from +5 to 35°C. It is not frost hardy.

11. HEALTH AND SAFETY WARNINGS AND RECOMMENDATIONS

Detailed information can be found in the manufacturer's Safety Data Sheet. The above data, recommendations and guidance are based on our best knowledge, research and experience and have been given in good faith in accordance with the policies of our company and our suppliers. The proposed procedures are considered common, but each user of this material should make sure in all possible ways, including checking the final product under appropriate conditions, that the materials supplied are suitable for achieving the intended purposes. Neither the Company nor its authorised agents can be held liable for any losses incurred as a result of the incorrect or misuse of its materials. Do not dispose of the product and/or empty containers in the environment. Refer to the latest SDS for more information on disposal.

ECOLOGY

Do not dispose of the product and/or empty containers in the environment. Refer to the latest safety data sheet for more information on disposal procedures

12. PRODUCER

SELENA FM S.A., Legnicka St. 48A;
54-202 Wrocław, Poland
www.matizol.com